

# PECO Part #UC050F

MFG:PECO  
MFG#:UC050F



The Most  
Helpful Brand  
In Car Washing

## RET ULTIMATE CONVEYOR 50' / FWP (REQUIRES CHAIN & ROLLERS)

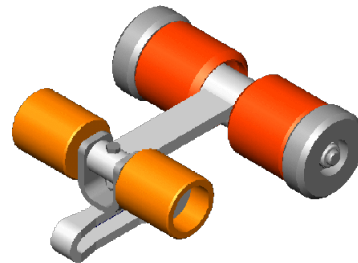

## Description

### Equipment Description:

The **PECO Ultimate Conveyor 2.0 TUF Series** is designed specifically for the carwash industry to provide safe vehicle travel through all stages of your carwash tunnel. This is a roller-on-demand conveyor. This allows the operator to call up the roller for each individual vehicle.

### This conveyor is standard with these important features:

- Entrance & Exit Rubber Trap Doors (22 Years Experience)
- 3/8" Thick Conveyor Steel throughout Structure
- Plastic Roller Guide Rail Standard on Outside Rail
- Removable Entrance Take-up Section
- All Hardware is Stainless Steel for Easy Maintenance
- Patented Plastic Middle Tier Guide System
- Entrance & Exit Steel Safety Plate
- Single Chain Operation
- Removable Idler Shaft for all Rollers
- Direct Drive Hydraulic Gear Box

This conveyor Includes:

1-Entrance Section

1-Exit Section

3-Center (10') Sections

# Specifications

## Hydraulic Requirements

Total System Hydraulic Requirements:	1	Banks	10	GPM
--------------------------------------	---	-------	----	-----

## Tunnel Controller Requirements

Total System Computer Requirements:	2	Outputs	0	Inputs
-------------------------------------	---	---------	---	--------

## Pneumatic Control Requirements

### Total System Pneumatic Control Requirements:

0.01	CFM
0.00	2W1 2-Way Valve
0.00	3W1 3-Way Valve
1.00	4W1 4-Way Valve
0.00	4WM 4-Way Valve Manual

## Water Requirements

### Total System WATER Requirements:

10.00	GPM @ 40psi Reclaim Water
0.00	GPM @ 40psi Fresh Water
0.00	GPM Soft Water
0.00	GPM Hot Water
0.00	GPM RO Water
0.00	GPM @ 850psi Reclaim Water
0.00	GPM @ 850psi High Pressure Water

## Water Controls Requirements

### Total System Water Control Requirements:

0	Solution Induction Pump (SIP)
0	1/2" Fresh Water Valve (1/2SOL)
0	3/4" Fresh Water Valve (3/4SOL)
0	1" Fresh Water Valve (1SOL)
1	3/4" Clay Valve (3/4CV)
0	1" Clay Valve (1CV)
0	1 1/2" Clay Valve (1.5CV)
0	1/2" High Pressure Valve (hpSOL)